

Extremadura

MINING INTERPRETATION CENTRE



The Mines of Cáceres



Mining Village

Archaeological, Industrial, and Mining Complex located in a neighbourhood of Aldea Moret.

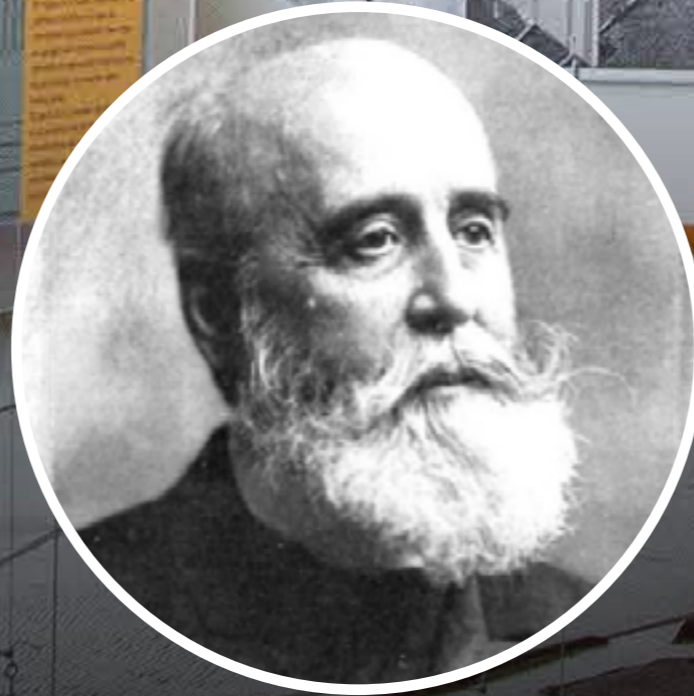

Segismundo Moret

Promoter of the General Society of Phosphates of Cáceres; of the development of mining in the city and its railway system



Phosphates

They are indispensable in our daily life; we find them in the agricultural, food, cosmetic, and pharmaceutical industry.

Extremadura

MINING INTERPRETATION CENTRE

Mining greatly influenced the economy and society of the 19th century, and the Barrio de Aldea Moret is one of the most important testimonies of the Industrial Heritage of Extremadura.



work is carried out at 185m of depth



Mining History

The centre also tells the story of the mine from its opening in 1864 until its total closure in 1960.

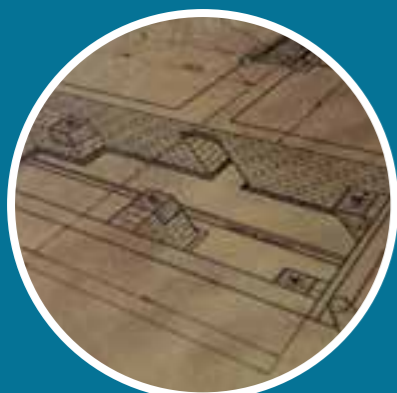

Under the surface

The lower level of the Abundancia Mine reached 185m deep with a whole network of wells, galleries, and chimneys.



Elevator tunnel

The old tunnel connecting the different levels is kept in very good condition. Its depth is surprising.



red.es



UNIÓN EUROPEA
Fondo Europeo de Desarrollo Regional
"Una manera de hacer Europa"